



Kuriyama Hydraulic

Connections™

STAINLESS STEEL FITTINGS



Kuriyama of America, Inc.



STAINLESS STEEL FITTINGS

ARE NOW PART OF



Kuriyama Hydraulic

 **Connections**™ 

What makes our stainless steel fittings better? Kuriyama Hydraulic Connections stainless steel fittings share crimp dimensions with our trusted Top Coat plated carbon steel fittings! Matching crimp dimensions for both lines takes the guess work and liability out of the distributor and end users hands. Both our Top Coat fittings and our new stainless steel fittings are manufactured by Alfagomma, SPA — the world class leader in hydraulic hose, fittings and quick release couplings. A proven validated crimp system from two world class leaders, Kuriyama and Alfagomma®.

Stainless steel fittings are now available for use on Kuriyama Hydraulic hoses

Some of these hoses include: TR1MT, T1SNTT, TR2MT, T2SNTT, TF2MT/ST, AT3KMT/ST, TR14TB, TR14C, TR5, TR5TT, ABT4K and TR4XF hoses.

Stainless steel fittings are available in the following popular configurations and sizes:

- MNPT – Male Pipe ¼" – 1"
- MNPS – Male Pipe Swivel - ¼" – 1"
- FJDH – Female JIC – ¼" – 1"

For more information, please contact us at sales@kuriyama.com

A Series Non-Skive Ferrules

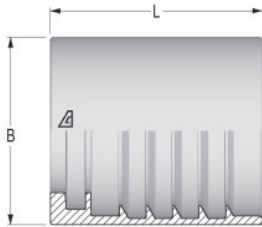

AF1 – Stainless Steel

NEW

Part Number	Dash Size	Hose ID Size		B OD (mm)	L Length (mm)	Weight (lbs/each)
		(in)	(mm)			
AF1-04-SS	04	1/4	6.4	22	24.7	0.06
AF1-06-SS	06	3/8	9.5	26	29.7	0.10
AF1-08-SS	08	1/2	12.7	29	30.5	0.11
AF1-10-SS	10	5/8	15.9	32	30.5	0.12
AF1-12-SS	12	3/4	19.0	36	36.0	0.17

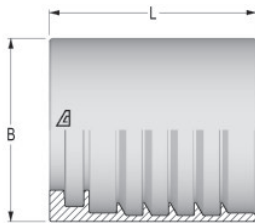

AF2 – Stainless Steel

NEW

Part Number	Dash Size	Hose ID Size		B OD (mm)	L Length (mm)	Weight (lbs/each)
		(in)	(mm)			
AF2-04-SS	04	1/4	6.4	23	24.7	0.07
AF2-06-SS	06	3/8	9.5	27	29.7	0.10
AF2-08-SS	08	1/2	12.7	30	30.5	0.12
AF2-10-SS	10	5/8	15.9	33	30.5	0.13
AF2-12-SS	12	3/4	19.0	37	36.0	0.18
AF2-16-SS	16	1	25.4	45	36.7	0.24

Because we continually examine ways to improve our products, we reserve the right to alter specifications or discontinue products without prior notice.

Two-Piece Fittings

- AFX, AFT Series



A Series Non-Skive Ferrules

AFX – Stainless Steel

NEW

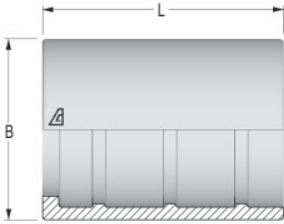

Part Number	Dash Size	Hose ID Size		B OD (mm)	L Length (mm)	Weight (lbs/each)
		(in)	(mm)			
AFX-04-SS	04	1/4	6.4	23	24.7	0.07
AFX-05-SS	05	5/16	7.9	25	24.7	0.08
AFX-06-SS	06	3/8	9.5	27	29.7	0.10
AFX-08-SS	08	1/2	12.7	30	30.5	0.11
AFX-10-SS	10	5/8	15.9	34	35.5	0.15
AFX-12-SS	12	3/4	19.0	38	36.0	0.17
AFX-16-SS	16	1	25.4	48	42.5	0.28

AFT – Stainless Steel

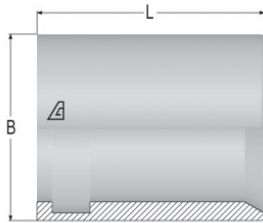

Part Number	Dash Size	Hose ID Size		B OD (mm)	L Length (mm)	Weight (lbs/each)
		(in)	(mm)			
AFT-03	03	3/16	4.8	14.0	20	0.02
AFT-04	04	1/4	6.4	15.0	25	0.03
AFT-05	05	5/16	7.9	17.2	25	0.04
AFT-06	06	3/8	9.5	22.0	25	0.07
AFT-08	08	1/2	12.7	25.0	30	0.08
AFT-10	10	5/8	15.9	30.0	33	0.11
AFT-12	12	3/4	19.0	35.0	37	0.15
AFT-16	16	1	25.4	42.0	45	0.26
AFT-20	20	1 1/4	31.8	50.0	48	0.34
AFT-24	24	1 1/2	38.1	57.0	58	0.48
AFT-32	32	2	50.8	73.0	67	0.73

Because we continually examine ways to improve our products, we reserve the right to alter specifications or discontinue products without prior notice.



Inserts for two-piece fittings – US End Configurations

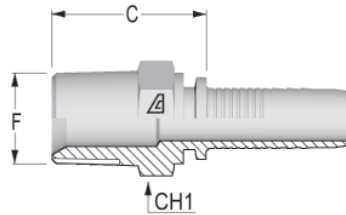

NEW

MNPT Male 60° Seat Stainless Steel

Part Number	Dash Size	Hose ID Size		F Thread		C Cut-Off Factor (mm)	Hex Dia. CH1 (mm)	Weight (lbs/each)
		(in)	(mm)	Dash Size	Size (in) - TPI			
A-0404-MNPT-SS	04	1/4	6.4	04	1/4-18	26.8	17	0.06
A-0606-MNPT-SS	06	3/8	9.5	06	3/8-18	27.8	19	0.09
A-0808-MNPT-SS	08	1/2	12.7	08	1/2-14	32.1	22	0.17
A-1008-MNPT-SS	10	5/8	15.9	08	1/2-14	32.1	27	0.23
A-1012-MNPT-SS	10	5/8	15.9	12	3/4-14	34.1	27	0.24
A-1212-MNPT-SS	12	3/4	19.0	12	3/4-14	34.6	27	0.26
A-1616-MNPT-SS	16	1	25.4	16	1-11 1/2	44.4	36	0.53

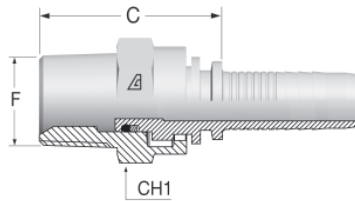

NEW

MNPS Male Swivel 60° Seat Stainless Steel

Part Number	Dash Size	Hose ID Size		F Thread		C Cut-Off Factor (mm)	Hex Dia. CH1 (mm)	Weight (lbs/each)
		(in)	(mm)	Dash Size	Size (in) - TPI			
A-0404-MNPS-SS	04	1/4	6.4	04	1/4-18	37.6	17	0.09
A-0606-MNPS-SS	06	3/8	9.5	06	3/8-18	37.5	22	0.15
A-0808-MNPS-SS	08	1/2	12.7	08	1/2-14	42.3	25	0.25
A-1008-MNPS-SS	10	5/8	15.9	08	1/2-14	45.1	27	.027
A-1012-MNPS-SS	10	5/8	15.9	12	3/4-14	47.3	27	0.29
A-1212-MNPS-SS	12	3/4	19.0	12	3/4-14	50.1	32	0.31
A-1616-MNPS-SS	16	1	25.4	16	1-11 1/2	57.9	41	0.63

Because we continually examine ways to improve our products, we reserve the right to alter specifications or discontinue products without prior notice.

Two-Piece Fittings - A Series

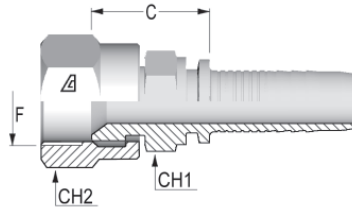

NEW

JIC Female 37° Seat – Double Hex Stainless Steel

Part Number	Dash Size	Hose ID Size		F Thread		C Cut-Off Factor (mm)	Hex Dia. CH1 (mm)	Hex Dia. CH2 (mm)	Weight (lbs/each)
		(in)	(mm)	Dash Size	Size (in) - TPI				
A-0404-FJDH-SS	04	1/4	6.4	04	7/16-20	19.6	14	16	0.06
A-0606-FJDH-SS	06	3/8	9.5	06	9/16-18	21.3	17	19	0.10
A-0808-FJDH-SS	08	1/2	12.7	08	3/4-16	25.6	19	25	0.2
A-1010-FJDH-SS	10	5/8	15.9	10	7/8-14	27.6	24	27	0.27
A-1212-FJDH-SS	12	3/4	19.0	12	1 1/16-12	28.6	27	32	0.35
A-1616-FJDH-SS	16	1	25.4	16	1 5/16-12	32.9	32	38	0.62

Because we continually examine ways to improve our products, we reserve the right to alter specifications or discontinue products without prior notice.

Cautionary Statement

All Products sold and distributed by Kuriyama of America, Inc. are commodities and are sold based on their ability to perform within each product's published specifications. The Products are not sold for particular purposes, uses or applications. Purchasers and users are solely responsible for determining whether the Products are suitable for the purchaser's or user's intended purposes, uses or applications. Purchasers and users shall conduct their own engineering studies or tests, or retain qualified engineers, consultants or testing laboratories before determining the proper use, suitability or propriety of the Products. Alfagomma and Piranha Hose hoses and fittings are designed, engineered and tested to be used together in an assembly. Alfagomma and Piranha Hose do not recommend or authorize the use of their hoses or fittings with another manufacturer's hoses or fittings, as doing so may result in unreliable or unsafe assemblies.

Purchasers and users should follow all instructions contained in the catalogs, brochures, technical bulletins and other documents of Kuriyama of America, Alfagomma and Piranha Hose. Kuriyama of America, Alfagomma and Piranha Hose recommend only those hose and coupling combinations specified in the applicable Hydraulic Products Catalogs. The Products, including but not limited to, hose, tubing or couplings, may fail due to the use or conveyance of substances at elevated or lowered temperatures or at excessive pressure, the conveyance of abrasive, injurious, flammable, explosive or damaging substances.

Hose or tubing used in bent configurations will be subjected to increased abrasion. Hose clamps or couplings may loosen after initial installation, and all sections of hose and tubing – including connections, couplings, clamps, conductivity and bonding – should be inspected frequently, regularly and consistently, and should be replaced, adjusted or re-tightened to avoid leakage, prevent injuries or damage, and for general safety purposes.

Purchasers or users of the Products should frequently and consistently undertake inspections and protective measures with respect to the use and application of Products, which should include the examination of tube and cover, conditions of the hose or tubing, and the identification, repair or replacement of sections showing cracking, blistering, separations, internal and external abrasions, leaking or slipped couplings or connections and make proper proof tests.

Kuriyama of America, Alfagomma and Piranha Hose shall not be liable or responsible for hose assemblies that have not been produced in conformance with their assembly recommendations and current crimp data charts.

Limited Warranty and Limitation of Liability

The Products sold or distributed by Kuriyama of America are warranted to its customers to be free from defects in material and workmanship at the time of shipment by us, subject to the following provisions. ALL WARRANTY CLAIMS SHALL BE MADE WITHIN SIX (6) MONTHS AFTER KURIYAMA OF AMERICA SHIPPED THE PRODUCTS. KURIYAMA OF AMERICA'S LIABILITY HEREUNDER IS LIMITED, AT KURIYAMA OF AMERICA'S EXCLUSIVE DISCRETION, TO 1) REFUND OF THE PURCHASE PRICE PAID TO IT FOR DEFECTIVE PRODUCTS; OR 2) REPLACEMENT OF ANY DEFECTIVE PRODUCT OR PART UPON ITS AUTHORIZED RETURN TO KURIYAMA OF AMERICA.

THIS LIMITED WARRANTY IS IN LIEU OF AND EXCLUDES ALL OTHER WARRANTIES, EXPRESSED, IMPLIED, STATUTORY, OR OTHERWISE CREATED UNDER APPLICABLE LAW INCLUDING, BUT NOT LIMITED TO, ANY WARRANTY OF MERCHANTABILITY AND ANY WARRANTY OF FITNESS FOR A PARTICULAR PURPOSE. IN NO EVENT SHALL KURIYAMA OF AMERICA, ALFAGOMMA OR PIRANHA HOSE BE LIABLE FOR SPECIAL, INCIDENTAL, OR CONSEQUENTIAL DAMAGES, INCLUDING LOSS OF PROFITS, WHETHER OR NOT CAUSED BY OR RESULTING FROM THE NEGLIGENCE OF KURIYAMA OF AMERICA, ALFAGOMMA OR PIRANHA HOSE.

IN ADDITION, THIS WARRANTY SHALL NOT APPLY TO ANY PRODUCTS OR PORTIONS THEREOF WHICH HAVE BEEN SUBJECTED TO ABUSE, MISUSE, IMPROPER INSTALLATION, MAINTENANCE, OR OPERATION, ELECTRICAL FAILURE OR ABNORMAL CONDITIONS, AND TO PRODUCTS WHICH HAVE BEEN TAMPERED WITH, ALTERED, MODIFIED, REPAIRED, REWORKED BY ANYONE NOT APPROVED BY SELLER, OR USED IN ANY MANNER INCONSISTENT WITH THE PROVISIONS OF THE "CAUTIONARY STATEMENT" ABOVE OR ANY INSTRUCTIONS, MATERIALS OR SPECIFICATIONS PROVIDED WITH OR FOR THE PRODUCT.

Because we continually examine ways to improve our products, we reserve the right to alter specifications or discontinue products without prior notice.



Kuriyama of America – HQ



Kuriyama of America – Houston



Kuriyama of America – Santa Fe Springs



Fortney Sales Co.



Eastern Rubber & Plastics Co.



Kuriyama De México

Distributed by:



Kuriyama of America, Inc.

Headquarters, Sales Office and Warehouse Location
360 E. State Parkway, Schaumburg, IL 60173-5335
Phone: (847) 755-0360 • Toll-free FAX: (800) 800-0320
International FAX: (847) 885-0996

Web Site: www.kuriyama.com
E-Mail: sales@kuriyama.com



CONTACT OUR SALES/WAREHOUSE LOCATIONS BELOW WHICH SERVE YOUR AREA

SOUTHWEST WAREHOUSE
KURIYAMA OF AMERICA, INC.
HOUSTON
200 PORTWALL STREET, SUITE 100
HOUSTON, TX 77029
Phone: (713) 674-8212
Toll Free Phone: (800) 501-6808
FAX: (713) 674-5214
Toll Free FAX: (800) 800-5214

WESTERN WAREHOUSE
KURIYAMA OF AMERICA, INC.
SANTA FE SPRINGS
10749 SHOEMAKER AVENUE
SANTA FE SPRINGS, CA 90670-4039
Phone: (562) 941-4507
FAX: (562) 941-8940
Toll-Free FAX: (800) 326-8940

SOUTHEAST WAREHOUSE
FORTNEY SALES CO., INC.
4221 CANTRELL ROAD NW
ACWORTH, GA 30101
PHONE: (770) 427-6528
FAX: (770) 423-9249
Toll Free FAX: (800) 423-9249
Web Site: www.fortneysales.com
E-Mail: sales@fortneysales.com

EASTERN WAREHOUSE
EASTERN RUBBER & PLASTICS CO., INC.
100 GOLDMAN DR.
PLUMSTED INDUSTRIAL PARK
CREAM RIDGE, NJ 08514
Phone: (609) 758-0100
FAX: (609) 758-0102
Toll Free FAX: (800) 445-7138
Web Site: www.easternrubber.com
E-Mail: sales@easternrubber.com

IN MEXICO:

KURIYAMA DE MÉXICO S DE RL DE CV
AV JOSE PALOMO MARTINEZ NO 520-20
BODEGA 5
PARQUE INDUSTRIAL OMOLAP
APODACA, N.L. CP:66633, MÉXICO
Phone: (81) 1086-1870 O 71
Toll-Free: (within Mexico) 01-800-822-52-00
FAX: (81) 1086-1869
Internet: www.kuriyama.com
Correo Electronico: ventas@kuriyama.com